

# SPECIFICATIONS

## ELECTRICAL

50 OHMS  
 VSWR 1.30:1 MAX  
 FREQUENCY: DC-23 GHZ

## MECHANICAL

ENVIRONMENTAL  
 -65 DEG C TO +165 DEG C

## MATERIALS

BODY: PASSIVATED STAINLESS STEEL  
 CENTER CONTACT: AU PLATED &  
 NICKEL PLATED BeCu  
 INSULATION: TEFLON  
 DURABILITY: 5000 CYCLES

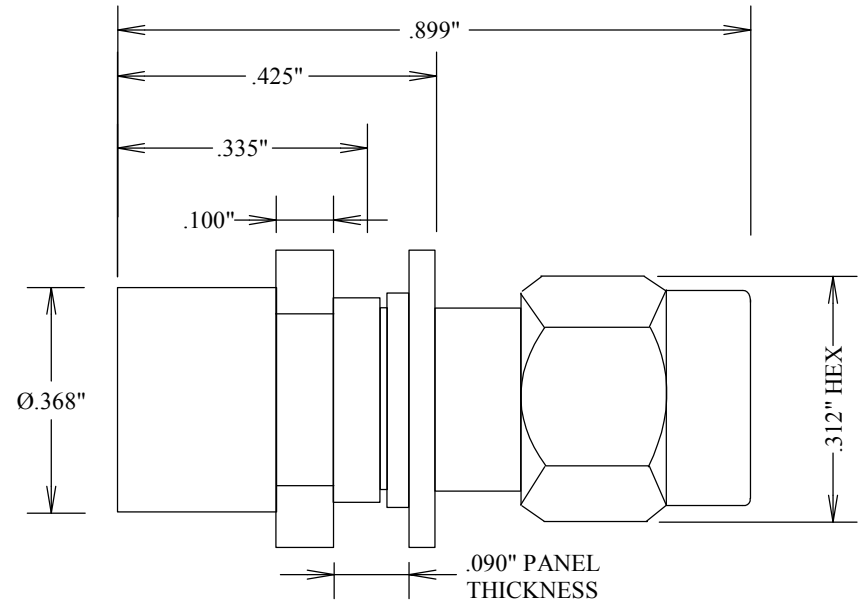
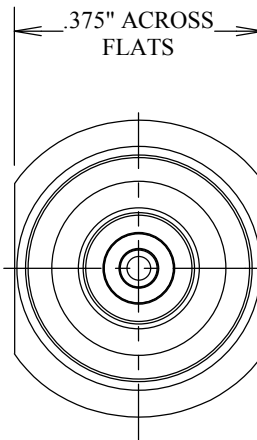

GMS JACK

SMA MALE

**FAIRVIEW MICROWAVE**

FAIRVIEW, TX 75069 WWW.FAIRVIEWMICROWAVE.COM

TITLE

**ADAPTER, GMS JACK-SMA MALE  
 BULKHEAD ADAPTER**

SIZE	CAGE CODE	DWG NO	REV
<b>A</b>	<b>3FKR5</b>	<b>SM2927</b>	<b>A</b>

SCALE	SHEET
-------	-------