

SPECIFICATIONS

ELECTRICAL

FREQUENCY: 0-7.5 GHZ
 IMPEDANCE: 50 OHMS
 VSWR: 1.2:1 MAX

MECHANICAL

MATERIALS BODY: NICKEL PLATED BRASS
 MATERIALS CONTACTS BeCu,
 CONTACT PLATING: Au PER MIL-G-45204
 INSULATOR: TEFLON
 RECOMMENDED TORQUE 7-16 221 IN-LBS
 DURABILITY: 500 CYCLES MIN

OPERATING TEMP: -65° TO +165° C

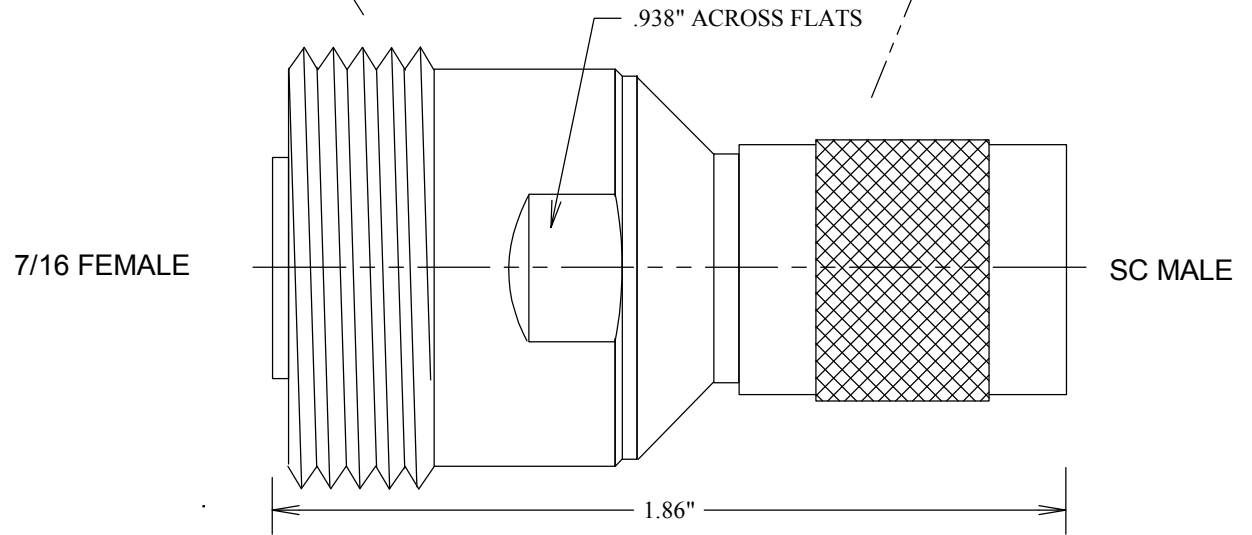
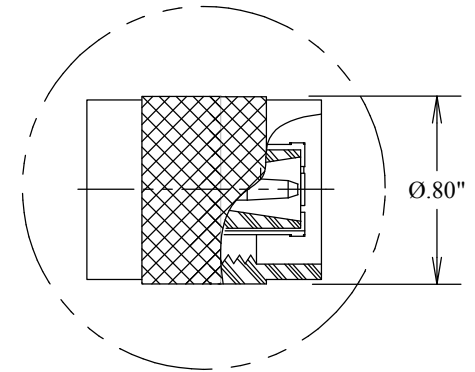
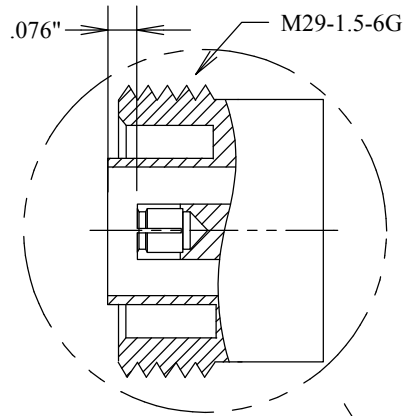

S. M. ELECTRONICS L.L.C.

FAIRVIEW, TX WWW.SMELECTRONICSLLC.COM

TITLE

SC MALE - 7/16 FEMALE ADAPTER

SIZE	CAGE CODE	DWG NO	REV
A	3FKR5	SM4645	--
SCALE	SHEET		