

SPECIFICATIONS

ELECTRICAL:

FREQUENCY: 0-18 GHZ
 IMPEDANCE: 50 OHMS
 OP. TEMP RANGE: -55C to +155C

MECHANICAL:

MATERIAL BODY: STAINLESS STEEL AU PLATING
 CENTER CONTACT: BeCu Au PLATED MIL-G-45204
 INSULATOR: TEFLON
 INTERFACE: MIL-STD-883A

SMA-F

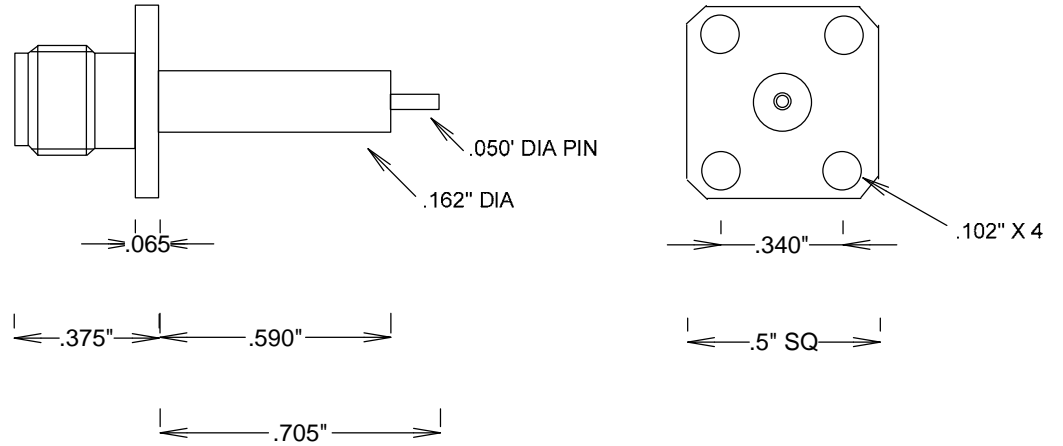

S. M. ELECTRONICS

FAIRVIEW, TX 75069 WWW.SMELECTRONICS.US

TITLE

SMA-F PANEL POST CONTACT

SIZE	CAGE CODE	DWG NO	REV
A	3FKR5	SC3730	--

SCALE	SHEET
-------	-------