

# SPECIFICATIONS

## ELECTRICAL:

FREQUENCY: 0-12 GHZ  
 VSWR 1.3:1 MAX  
 IMPEDANCE: 50 OHMS

## MECHANICAL:

MATERIAL BODY: NICKLE PLATED BRASS  
 CENTER CONTACT: BRASS  
 CONTACT PLATING: Si QQ-S-365  
 INSULATOR: TEFLON  
 CAPTIVATED CONTACT  
 INTERFACE: MIL-STD-348B  
 ROHS COMPLIANT  
 OP. TEMP RANGE: -55°C- +155°C

## ASSEMBLY INSTRUCTIONS:

TRIM CABLE TO OVERALL LENGTH AS SHOWN;  
 SLIDE BACKNUT, WASHER, GASKET, CLAMP ON CABLE;  
 COMB BRAID WIRES OUT, FOLD BACK, TRIM FLUSH W CLAMP;  
 TRIM DIELECTRIC & CENTER PIN AS SHOWN;  
 ASSEMBLE REAR BUSHING;  
 SOLDER CONTACT ONTO CENTER CONDUCTOR,  
 INSERT ASSEMBLY INTO BODY, TIGHTEN NUT

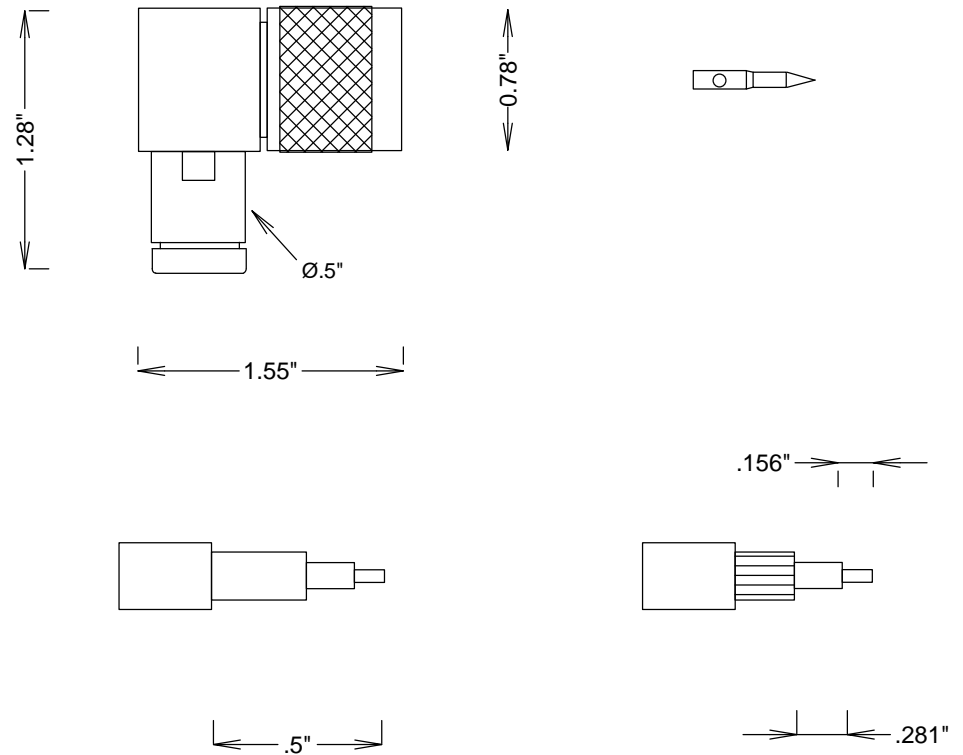

STRIPPING DIMENSIONS

				<b>S. M. ELECTRONICS L.L.C.</b>			
				FAIRVIEW, TX 75069 WWW.SMELECTRONICS.US			
				TITLE			
				<b>N-M CLAMP R ANGLE RG55, RG58</b>			
SIZE		CAGE CODE		DWG NO		REV	
<b>A</b>		<b>3FKR5</b>		<b>SC9189</b>		<b>--</b>	
SCALE				SHEET			