

N-PLUG PANEL SOLDER POT

SC9213

SPECIFICATIONS

ELECTRICAL:

FREQUENCY: 0-11 GHZ
 IMPEDANCE: 50 OHMS

MECHANICAL:

MATERIAL BODY: BRASS NICKLE PLATING
 CENTER CONTACT: BRASS Si PLATED QQ-S-365
 CAPTIVATED CONTACT
 INSULATOR: TEFLON
 INTERFACE: MIL-STD-883A
 N: MIL-PRF-39012
 OP. TEMP RANGE: -55°C to +165°C
 ROHS COMPLIANT

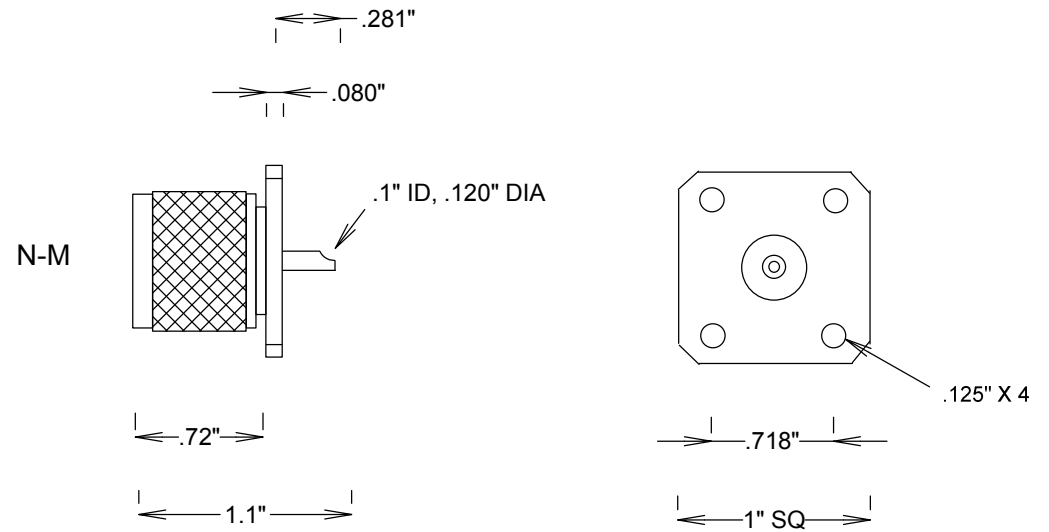

FAIRVIEW MICROWAVE INC.

ALLEN, TX 75013 WWW.FAIRVIEWMICROWAVE.COM

TITLE

N-PLUG PANEL SOLDER POT

SIZE	CAGE CODE	DWG NO	REV
A	3FKR5	SC9213	--

SCALE	SHEET
-------	-------