

# SPECIFICATIONS

## ELECTRICAL:

FREQUENCY: 0-6 GHZ  
 VSWR 1.25:1 MAX  
 IMPEDANCE: 50 OHMS  
 OP. TEMP RANGE: -55C to +125C

## MECHANICAL:

MATERIAL BODY: BRASS AU PLATING  
 CENTER CONTACT: BeCu  
 CONTACT PLATING: Au MIL-G-45204  
 CAPTIVATED CONTACT  
 INSULATOR: TEFLON  
 ROHS COMPLIANT

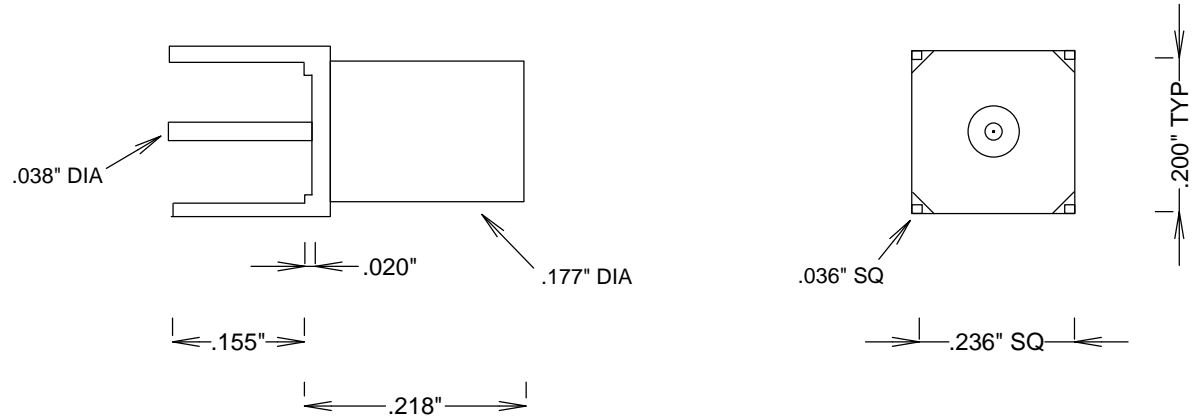

MAX BOARD .100"

				<b>S. M. ELECTRONICS L.L.C.</b>	
				FAIRVIEW, TX 75069 <a href="http://WWW.SMELECTRONICS.US">WWW.SMELECTRONICS.US</a>	
				TITLE	
				<b>MCX-JACK PCB</b>	
		SIZE	CAGE CODE	DWG NO	REV
		<b>A</b>	<b>3FKR5</b>	<b>SC9481</b>	<b>--</b>
				SCALE	SHEET