

SPECIFICATIONS

ELECTRICAL:

FREQUENCY: 0-6 GHZ
 VSWR 1.25:1 MAX
 IMPEDANCE: 50 OHMS
 OP. TEMP RANGE: -55C to +125C

MECHANICAL:

MATERIAL BODY: BRASS AU PLATING
 CENTER CONTACT: BeCu
 CONTACT PLATING: Au MIL-G-45204
 CAPTIVATED CONTACT
 INSULATOR: TEFLON
 ROHS COMPLIANT

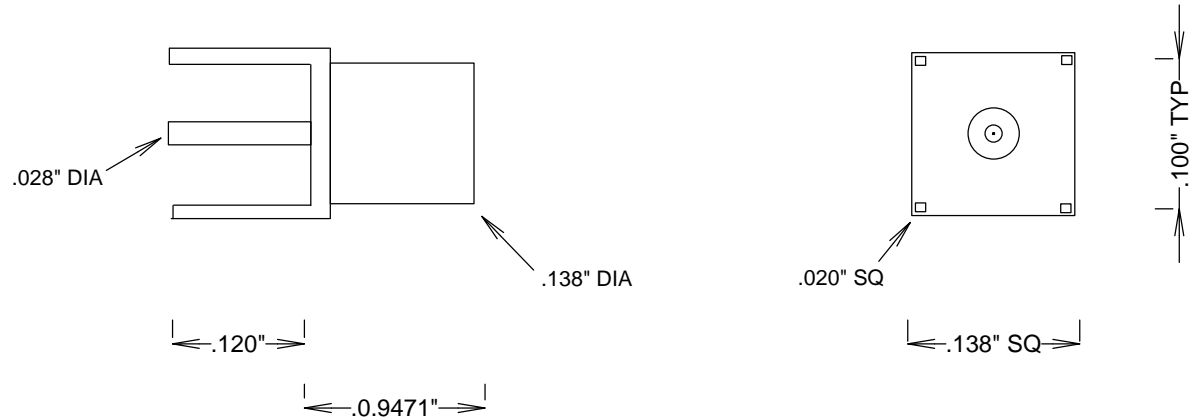

MAX BOARD .100"

				S. M. ELECTRONICS L.L.C.			
				FAIRVIEW, TX 75069 WWW.SMELECTRONICS.US			
				TITLE			
				MMCX-JACK PCB			
SIZE		CAGE CODE		DWG NO		REV	
A		3FKR5		SC9572		--	
SCALE				SHEET			