

SPECIFICATIONS

ELECTRICAL:

FREQUENCY: 0-4 GHZ
 IMPEDANCE: 50 OHMS

MECHANICAL:

MATERIAL BODY: Ni PLATED BRASS
 CENTER CONTACT: BeCu
 CONTACT PLATING: Si QQ-S-365
 CAPTIVATED CONTACT
 INSULATOR: TEFLON
 INTERFACE: MIL-STD-883A
 ROHS COMPLIANT
 OP. TEMP RANGE: -55°C to +155°C

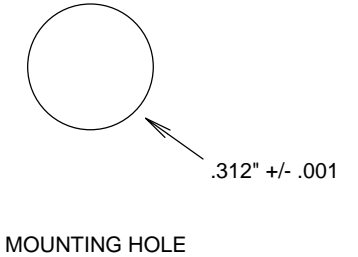
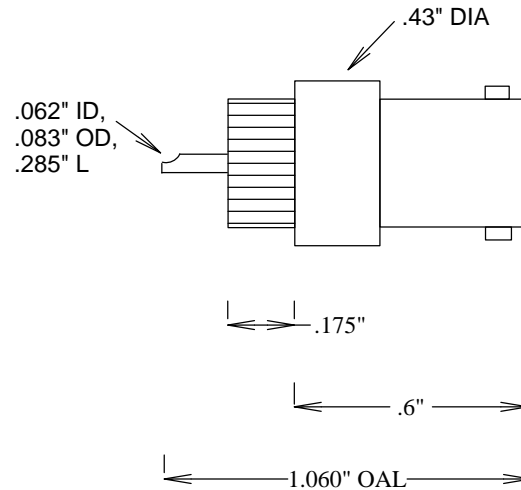

.150" MAX PANEL

				S. M. ELECTRONICS L.L.C.			
				FAIRVIEW, TX 75069 WWW.SMELECTRONICS.US			
				TITLE			
				BNC PRESSMOUNT			
SIZE	CAGE CODE	DWG NO		REV			
A	3FKR5	SC6201		--			
SCALE			SHEET				