

 **TRILITHIC**
Specification Sheet
MODEL XWPD-524-8-SMA-R
2-Way Broadband Power Divider

Frequency Range: 4-8GHz
Impedance: 50 Ohms nominal
Configuration: 2-Way
Isolation: 20dB minimum
Insertion Loss: 0.5 dB maximum
(above theoretical split)
Amplitude Tracking: +/- 0.3dB maximum
Phase Tracking: +/- 3 deg. maximum
VSWR: 1.25:1 maximum
Power Input: 30 Watts
RF Connectors: SMA Female
Operating Temperature: -55 deg. to +85deg. C

ECR/PRR #	Date	APPR

Approved By: _____

Approved Internet/Email Copy

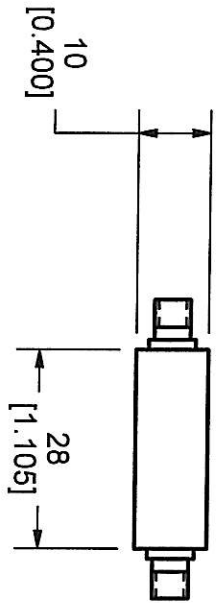
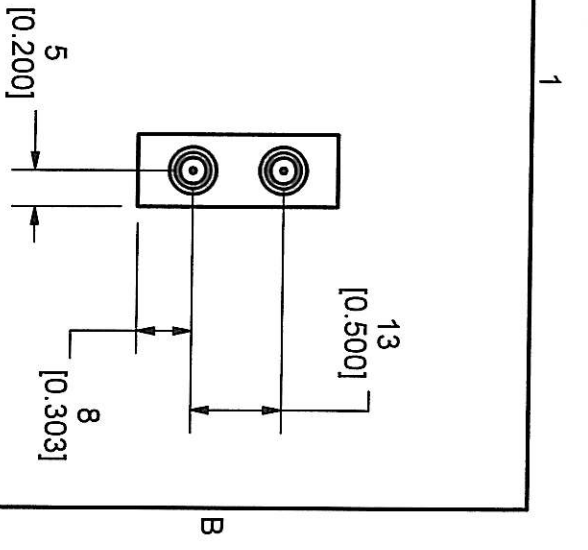
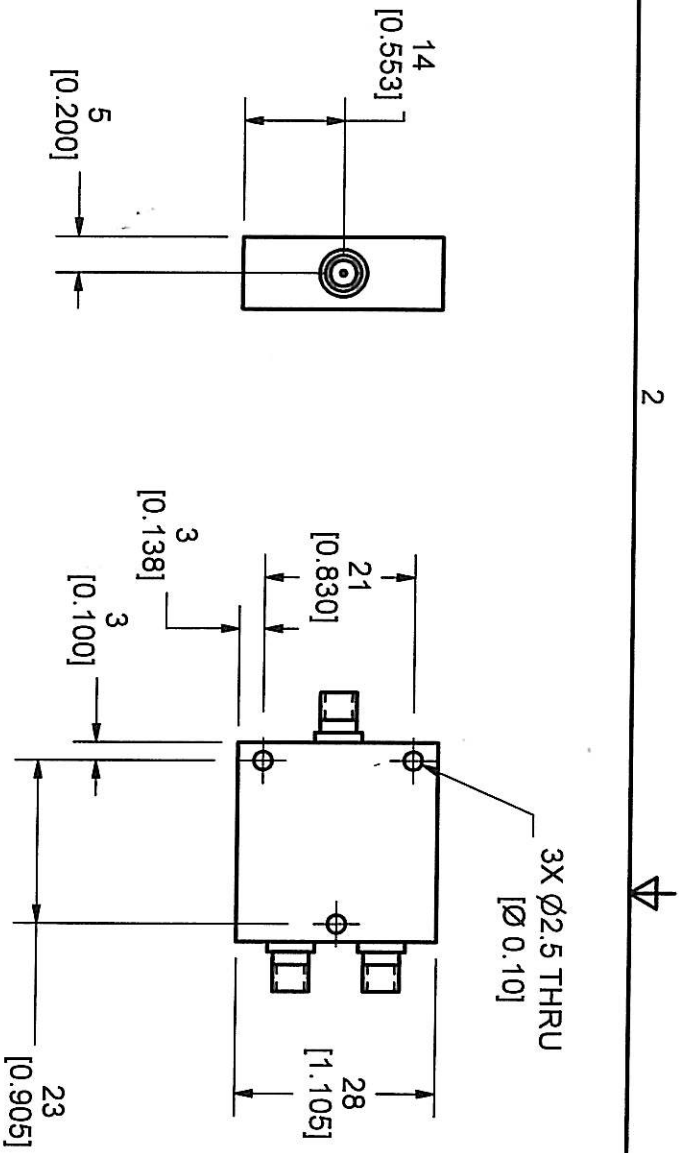

DIMENSIONS ARE IN INCHES UNLESS OTHERWISE SPECIFIED.
TOLERANCES ARE:

DEC. XX #	FRAC #
XXX ± .005	ANG #

REMOVE BURRS, BREAK SHARP EDGES.
WITHOUT WRITTEN CONSENT

THIS PRINT INCLUDING THE PRINCIPLE OF DESIGN IS THE PROPERTY OF AND SUBMITTED BY TRILITHIC CORP. WITH THE UNDERSTANDING THAT IT IS NOT TO BE USED FOR ANY PURPOSE WITHOUT WRITTEN CONSENT

TRILITHIC
Indianapolis, Indiana, U.S.A.
XWPD-524-8-SMA-R

MATERIAL		SIGNATURES		DATE	
N/A		DR			
FINISH		CHK			
N/A		APPD			
		APPD			

SIZE	CAGE	DWG NO.	REV
A	23042	---	-

DO NOT SCALE DRAWING SCALE SHEET 1 OF 1

2

1

A

B

B

A