

# SPECIFICATIONS

## ELECTRICAL:

FREQUENCY: 0-6 GHZ  
 VSWR @ 6 GHZ: 1.15:1 MAX  
 POWER (AVG) 1.0 WATTS @ 25 DEG C;  
 1/2 WATT @ 125 DEG C  
 POWER (PEAK) 1KW/50 MICRO-S  
 IMPEDANCE: 50 OHMS  
 OP. TEMP RANGE: -55C- +125C

## MECHANICAL:

MATERIAL COUPLING NUT: TRIMETAL PLATED BRASS  
 MATERIAL BODY: GOLD PLATED BRASS  
 CENTER CONTACT: GOLD PLATED PER MIL-G-45204  
 RESISTIVE ELEMENT: THIN FILM ON ALUMINA SUBSTRATE  
 RECOMMENDED TORQUE: 5-7 IN-LBS

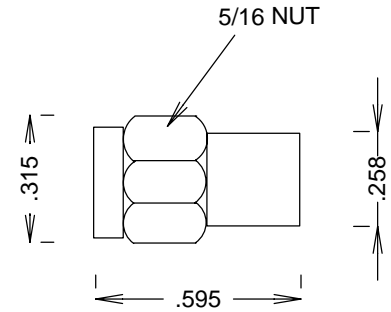

DBD COMMUNICATIONS LINE CARD

TITLE

**TERMINATION 6GHZ SMA-MALE**

| SIZE     | CAGE CODE    | DWG NO        | REV |
|----------|--------------|---------------|-----|
| <b>A</b> | <b>3FKR5</b> | <b>ST0645</b> | -   |
| SCALE    |              | SHEET         |     |