

SPECIFICATIONS

ELECTRICAL:

FREQUENCY: 0-26.5 GHZ
 VSWR 1.3:1 MAX
 POWER (AVG) 1 WATT
 POWER (PEAK) 250W/5 MICRO-S
 IMPEDANCE: 50 OHMS
 OP. TEMP RANGE: -55C- +125C

MECHANICAL:

MATERIAL BODY: PASSIVATED STAINLESS STEEL
 CENTER CONTACT: GOLD PLATED PER MIL-G-45204
 INSULATOR: TEFLON
 CHAIN: PASS S STEEL
 ROHS COMPLIANT

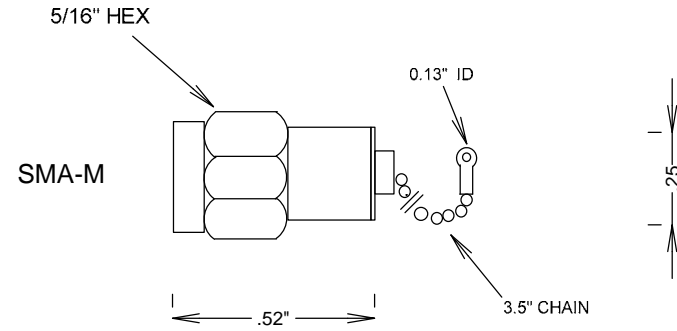

				S. M. ELECTRONICS	
				FAIRVIEW, TX 75069 WWW.SMELECTRONICS.US	
				TITLE	
				TERMINATION 26.5GHZ SMA-M w CHAIN	
SIZE		CAGE CODE	DWG NO		REV
A		3FKR5	ST2658C		--
SCALE				SHEET	