

SPECIFICATIONS

ELECTRICAL:

FREQUENCY: 0-50 GHZ
 VSWR @ 50GHZ: 1.30:1 MAX
 POWER (AVG) 0.5 WATTS
 POWER (PEAK) 100W
 IMPEDANCE: 50 OHMS
 OP. TEMP RANGE: -65C- +125C

MECHANICAL:

MATERIAL BODY: PASSIVATED STAINLESS STEEL
 CENTER CONTACT: GOLD PLATED PER MIL-G-45204
 RECOMMENDED MATING TORQUE: 7-10 IN-LBS

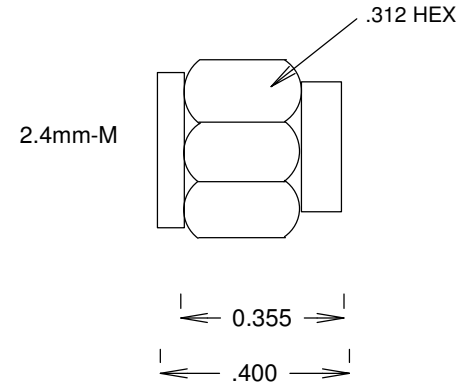

DBD COMMUNICATIONS LINE CARD

TITLE

TERMINATION 50 GHZ 2.4-MALE

SIZE	CAGE CODE	DWG NO	REV
A		ST5035	---

SCALE	SHEET